

JOHN FIG 4B

Bronze
Swing Check
Valve

The John Fig 4B bronze swing check valve is designed for non-return duties in either horizontal or vertical pipelines conveying water and other fluids. Suitable for applications in mechanical services domestic water systems, fire protection, hospital equipment, and general industry services within pressure limitations. Ends Screwed BSP.

Valve Overview*

Body Material	Bronze
Size Range	DN15 – DN100
Temperature	Up to 175°C
Max Working Pressure	Water, Oil, Gas 2100 kpa @ 99°C
Hydrostatic Pressure	3150 kPa Seat: 2310 kPa
Connections	Ends Screwed BSP

Materials

ITEM	PART	MATERIAL
1	Body	Bronze
2	Bonnet	Bronze
3	Disc	Bronze
4	Disc Nut	Brass
5	Hinge	Bronze
6	Hinge Pin & Nut	Brass

Dimensions (measurements in mm)

Size	A	B	Kg
15	68	33	0.4
20	76	44	0.6
25	92	52	0.9
32	121	70	1.7
40	127	76	2.3
50	140	86	3.2
65	187	114	5.8
80	210	124	8.1
100	254	149	14.6

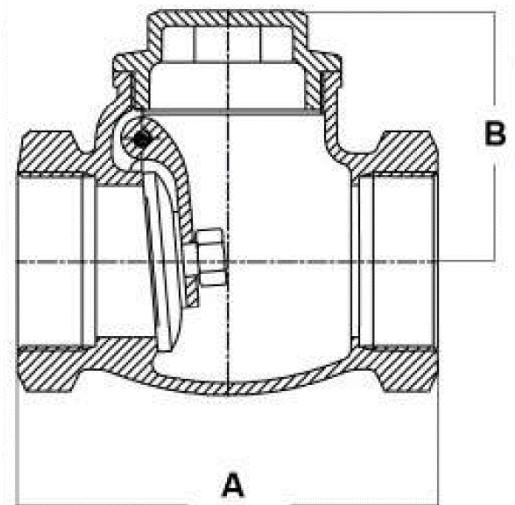

HEAD OFFICE: 19 Martin Drive, Delacombe, VIC, 3356 | (03) 5336 2113
WA: (08) 9249 1942 NSW: 0447 327 312 | QLD: 0427 784 419 | SA: 0418 503 570
sales@johnvalves.com.au | johnvalves.com.au

John Valves Pty Ltd Reserve the right to change materials and/or dimensions without notice 01/24

JOHN VALVES™
The Valve People Since 1896