

JOHN 4BF

Bronze
Swing
Check Valve

The John Fig 4BF bronze swing check valve is designed for non-return duties in either horizontal or vertical pipelines conveying water or other fluids. Suitable for applications in mechanical services, domestic water systems, fire protection, hospital equipment, and general industry services within the pressure limitations.

Valve Overview

Body Material	Bronze
Size Range	DN25-DN100
Max Working Pressure	Water, Oil, Gas 2100 kpa @ 99° C
Hydrostatic Test Pressure	Body: 3150 kpa Seat: 2310 kpa
Temperature	Up to 175°C
Flanges	Ends flanged AS2129 Table F - Undrilled, and can be drilled to your specification

Materials

ITEM	PART	MATERIAL
1	Body	Bronze
2	Bonnet	Bronze
3	Disc	Bronze
4	Disc Nut	Brass
5	Hinge	Bronze
6	Hinge Pin & Nut	Brass

Dimensions (mm)

Size	A	B	C	Kg
25	114	120	11	3.2
40	140	140	13	5.4
50	165	165	13	9.4
65	190	185	14	14
80	216	205	16	15
100	254	230	19	24

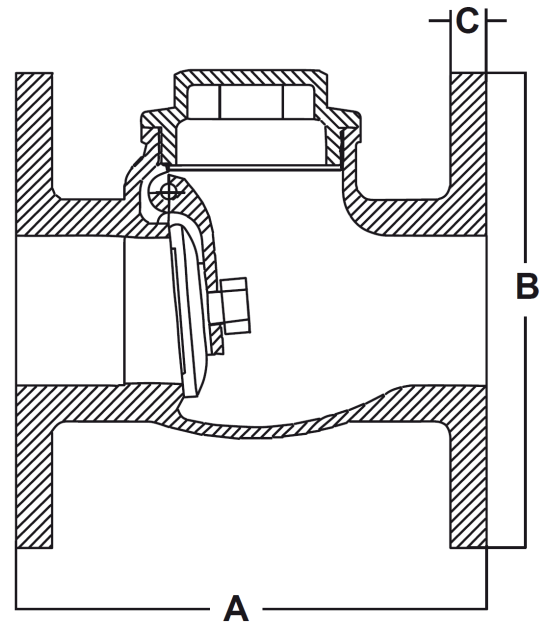

HEAD OFFICE: 19 Martin Drive, Delacombe, VIC, 3356 | (03) 5336 2113
WA: (08) 9249 1942 NSW: 0447 327 312 | QLD: 0427 784 419 | SA: 0418 503 570
sales@johnvalves.com.au | johnvalves.com.au

John Valves Pty Ltd Reserve the right to change materials and/or dimensions without notice 01/24

JOHN VALVESTM
The Valve People Since 1896