

JOHN PH404E

Cast Iron
Check Valve

The Fig PH404E cast iron swing check valves, also known as reflux valves, are designed to give full bore flow on liquid lines. They can be used in both horizontal and vertical applications with equal success.

Valve Overview

Body Material	Cast Iron
Size Range	DN50-DN300
Max Working Pressure	Water 1400 kpa @ 95° C
Hydrostatic test Pressure	Body: 2100 kpa Seat: 1400 kpa
Flanges	AS2129 Table 'E', ANSI-125 and Undrilled.



Materials

ITEM	PART	MATERIAL
1	Body	Cast Iron
2	Cover	Cast Iron
3	Disc	Cast Iron
4	Hinge	Ductile Iron
5	Body Seat Ring	Cast Bronze
6	Disc Seat Ring	Cast Bronze
7	Hinge Pin	Stainless Steel

Dimensions (measurements in mm)

Size	A	B	Kg
50	203	111	10
65	216	127	12
80	241	139	16
100	292	158	25
125	330	190	40
150	356	203	50
200	495	246	87
250	622	282	144
300	698	330	215

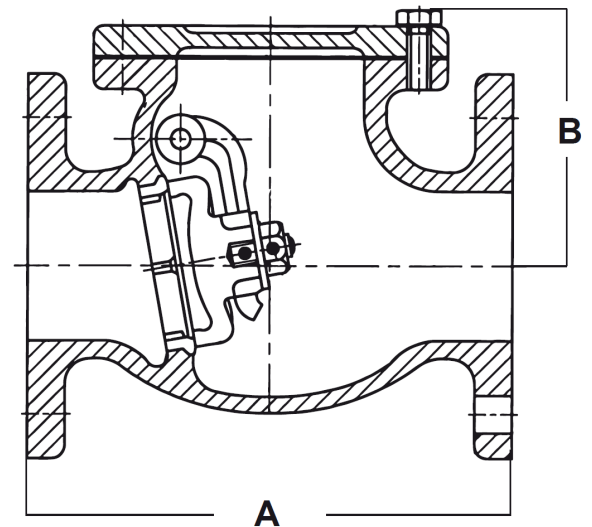

HEAD OFFICE: 19 Martin Drive, Delacombe, VIC, 3356 | (03) 5336 2113
WA: (08) 9249 1942 NSW: 0447 327 312 | QLD: 0427 784 419 | SA: 0418 503 570
sales@johnvalves.com.au | johnvalves.com.au

John Valves Pty Ltd Reserve the right to change materials and/or dimensions without notice 01/24

JOHN VALVES[™]
The Valve People Since 1896